



24 LINGFIELD GREEN, DARLINGTON, DL1 1DD

Offers In The Region Of £125,000

Situated in the ever popular Eastbourne area of Darlington, we are delighted to offer for sale this **THREE BEDROOM** property. Benefitting from being tucked away in a quiet cul de sac.

Internally the property comprises of; Reception Hallway, Lounge, Kitchen. To the first floor there are Three Bedrooms and a Bathroom.





GROUND FLOOR
406 sq.ft. (37.7 sq.m.) approx.

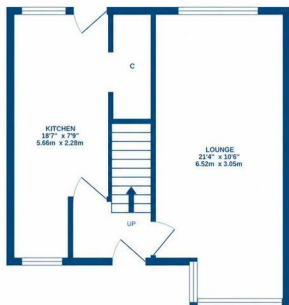

1ST FLOOR
409 sq.ft. (38.0 sq.m.) approx.



TOTAL FLOOR AREA: 815 sq.ft. (75.7 sq.m.) approx.
Not to scale for general guidance only. Made with Everplan 12/22

Energy Efficiency Rating

	Current	Potential
Very energy efficient - lower running costs		
(92 plus) A		
(81-91) B		
(69-80) C		
(55-68) D		
(39-54) E		
(21-38) F		
(1-20) G		
Not energy efficient - higher running costs		
England & Wales	EU Directive 2002/91/EC	

Environmental Impact (CO₂) Rating

	Current	Potential
Very environmentally friendly - lower CO ₂ emissions		
(92 plus) A		
(81-91) B		
(69-80) C		
(55-68) D		
(39-54) E		
(21-38) F		
(1-20) G		
Not environmentally friendly - higher CO ₂ emissions		
England & Wales	EU Directive 2002/91/EC	

YOUR HOME IS AT RISK IF YOU DO NOT KEEP UP REPAYMENTS ON A MORTGAGE OR OTHER LOANS SECURED ON IT.

These particulars do not constitute, nor constitute part of, an offer or contract. An intending purchaser must satisfy himself by inspection or otherwise as to the correctness of each of the statements contained in these particulars. The vendor does not make or give, and neither Ann Cordey, or any other person in their employment has any authority to make or give any representation or warranty whatever in relation to this property. All measurements are approximate.

